

COMMERCIAL & COMMUNITY HYDRANT POST/BOLLARD TYPICAL SPACING

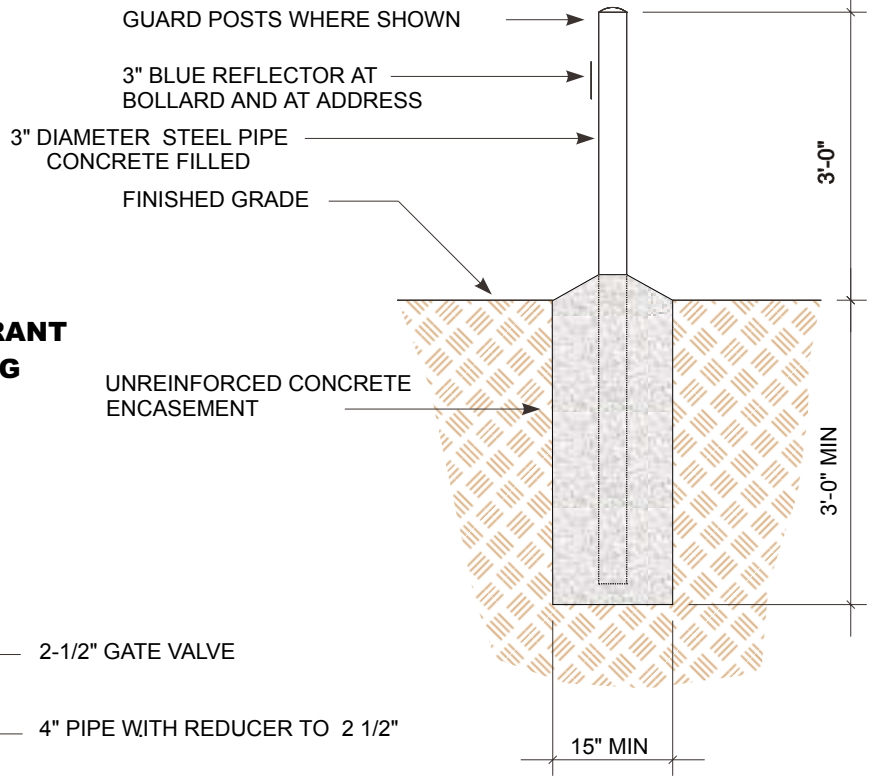

COMMERCIAL BOLLARD

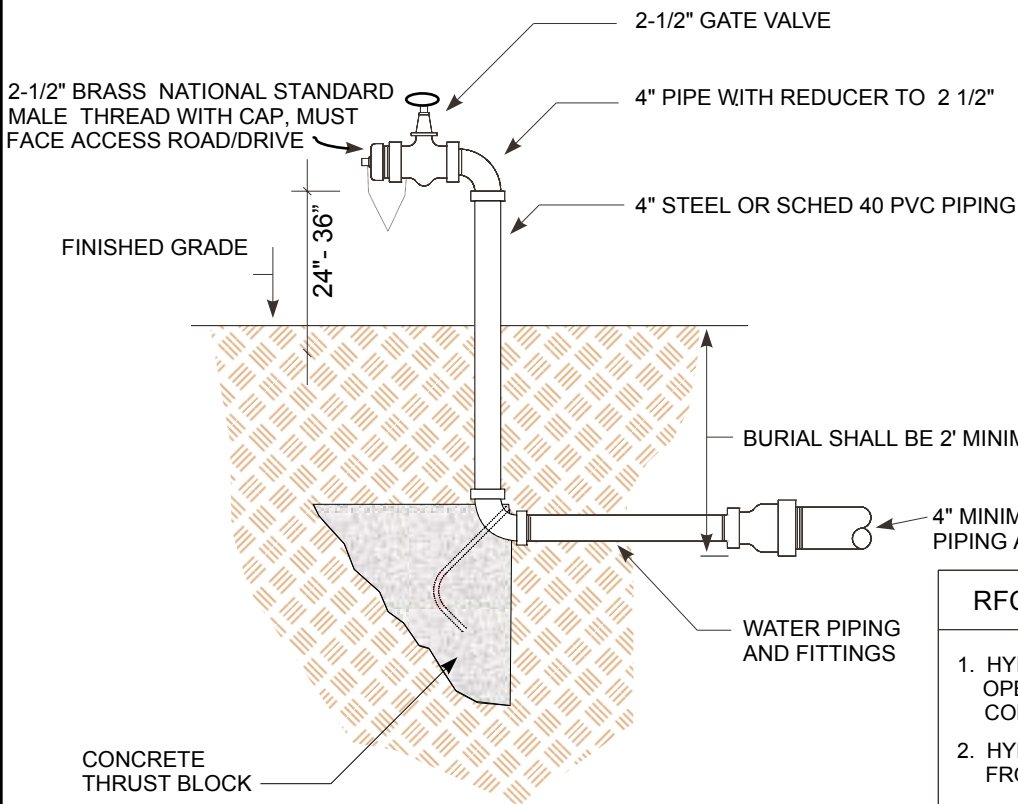

RESIDENTIAL FIRE CONNECTION (RFC)

RFC/HYDRANT INSTALLATION NOTES

1. HYDRANT SHALL BE INSTALLED AND OPERATING PRIOR TO AND DURING CONSTRUCTION.
2. HYDRANT SHALL BE INSTALLED WITHIN 8-10 FT FROM EDGE OF ROAD WITH 3" BLUE REFLECTOR.
3. RFC OUTLET SHALL BE 24"-36" ABOVE FINISHED GRADE & MUST HAVE BRASS OR PLASTIC CAP. MUST BE LOCATED AT LEAST 50' AND NOT MORE THAN 150' AWAY FROM STRUCTURE(S).

RESIDENTIAL FIRE CONNECTION (RFC) & GUARD POSTS

FIRE SAFE EXHIBIT

*CAL FIRE/SLO COUNTY FIRE DEPARTMENT
FIRE PREVENTION*

635 N. Santa Rosa Avenue
San Luis Obispo, California 93405
Telephone (805) 543-4244 Fax (805) 543-4248

1/2" = 1'-0"

SCALE

AUGUST 2011

3

EXHIBIT NO.